



CITY of **BOSTON**



2024 - 2025 PROJECT SITES

CALL TO ARTISTS

*A Canvas of Culture:
Boston Public Schools*

LED BY
**THE MAYOR'S OFFICE OF
ARTS AND CULTURE**

OPPORTUNITY 1

Call to Artists: A Canvas of Culture- BPS Murals | Project Sites
Charlestown High School | 240 Medford St. , Charlestown, MA 02129

Interior/ Exterior	Exterior
Location	Main school entrance
Substrate	Brick
Dimensions	20'w x 40'h
Budget	\$45,000

Themes:
Celebrating its diversity and inclusivity and artistically representing the school's unique learning communities - Dream Academy, Marathon Academy, and Unity Academy - highlighting themes of unity, support, and the exchange of ideas across cultures and languages. As one of five open enrollment schools, Charlestown HS represents the widest cross-section of the city across language, race & ethnicity.

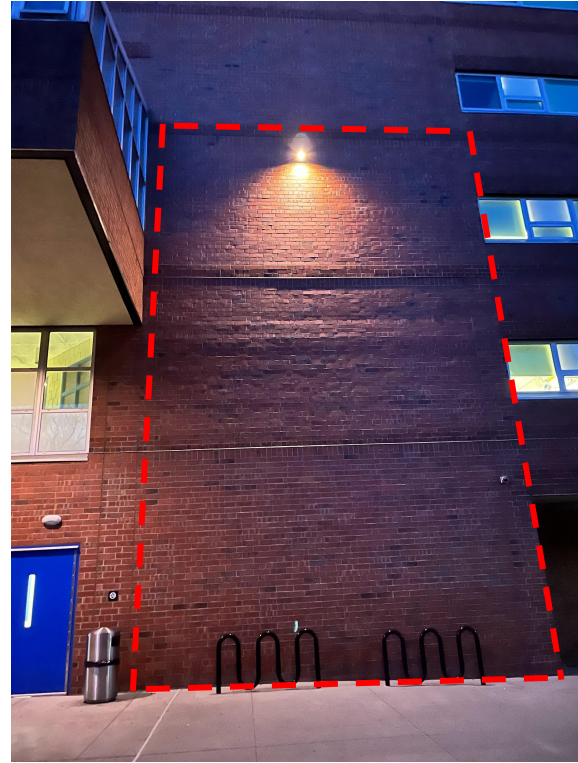

Call to Artists: A Canvas of Culture- BPS Murals | Project Sites
Curtis Guild Elementary School | 95 Leyden St. , East Boston, MA 02128

Interior/ Exterior	Exterior
Location	Main school entrance
Substrate	Brick
Dimensions	20'w x 40'h
Budget	\$40,000

Themes:

Artwork that evokes a warm, welcoming atmosphere, celebrating diversity, vibrant flowers, animals, and multilingualism. School's core values: kindness, community, creativity, respect, and excellence, affirming each student's heritage and potential. The design should make everyone feel seen, cared for, and proud to be part of a joyful, inclusive community.

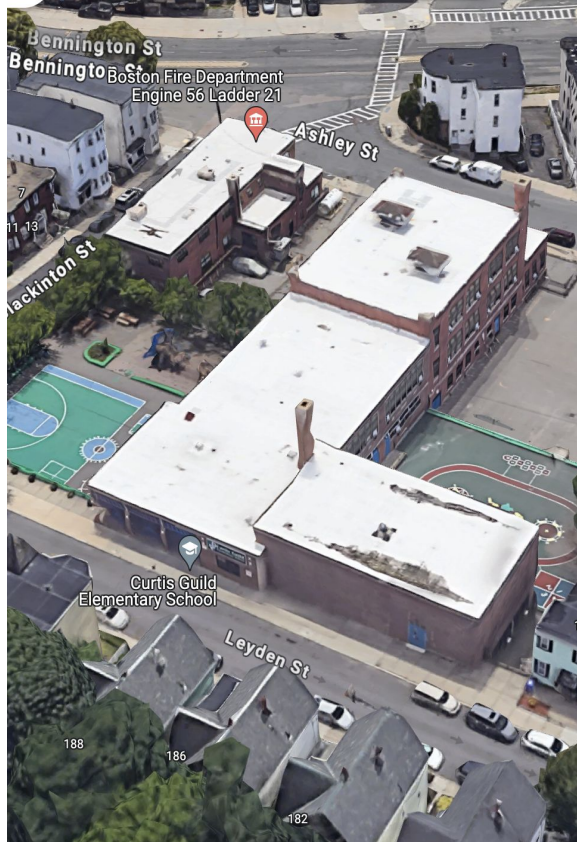

Call to Artists: A Canvas of Culture- BPS Murals | Project Sites
Mario Umana Academy | 312 Border St., East Boston, MA 02128

Interior/ Exterior	Interior
Location	Multi purpose, community room
Substrate	Brick
Dimensions	72' w X 12'h
Budget	\$40,000

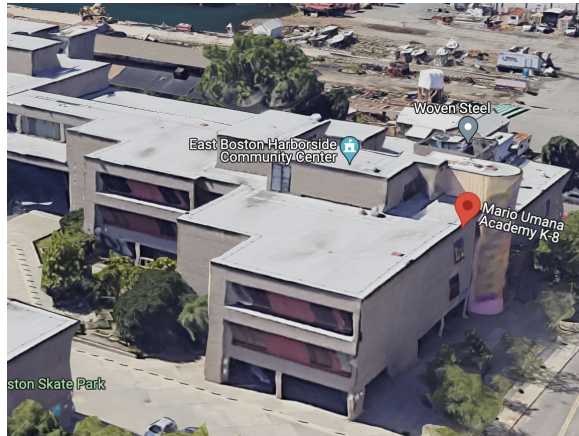

Themes:

Celebrate bilingualism and dual immersion, emphasizing the school's commitment to inclusivity and respect for diverse languages, including non-verbal communication. It should reflect the joy of learning in a multigenerational, multiethnic community, connected to East Boston's unique cultural tapestry, and embody the school's core values of bilingualism, respect, inclusivity, and joy. "Umana Oro"

Call to Artists: A Canvas of Culture- BPS Murals | Project Sites
Phineas Bates Elementary | 426 Beech St., Roslindale, MA 02131

Interior/ Exterior	Interior
Location	At entrance vestibules
Substrate	Cement center block
Dimensions	Wall 1- 10' 5" w x 6'1" h, Wall 2- 7'w x 4'2" h
Budget	\$20,000

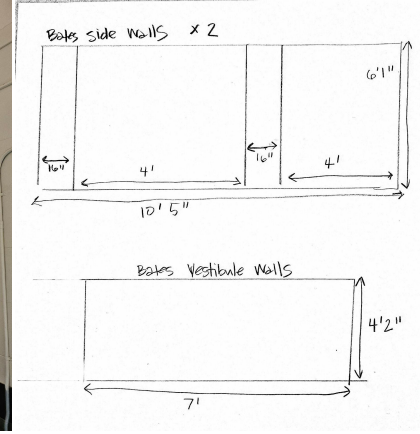

Themes:

2D Mural Mosaic: The design should be welcoming and warm, creating an inviting atmosphere and embodying full inclusion, reflecting the diversity of its community.



Call to Artists: A Canvas of Culture- BPS Murals | Project Sites
Lee Academy Pilot School | 25 Dunbar Ave., Dorchester, MA 02124

Interior/ Exterior	Exterior Left
Location	Main school entrance
Substrate	Brick
Dimensions	27'w x 45'h
Budget	\$60,000

Themes:

Catering to K0-Kinder, mural will be the backdrop of a planned exploratory play area. Artwork should be vibrant, fun, inspirational and representative of the school's diverse community. Elements should resonate with early childhood students, such as playful depictions of nature, gardening, and the school mascot, the honey-bee, in a way that makes them feel seen and proud of their learning environment.

*Artists proposing for both sites at this school may be considered.

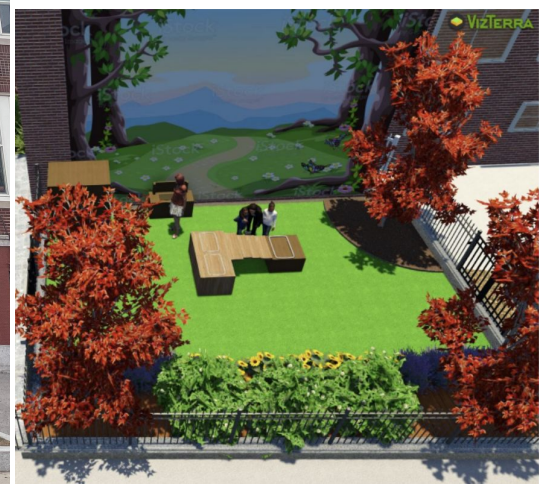

Kindergarten Exploratory Play Area Plan

Call to Artists: A Canvas of Culture- BPS Murals | Project Sites
Lee Academy Pilot School | 25 Dunbar Ave., Dorchester, MA 02124

Interior/ Exterior	Exterior Right
Location	Main school entrance
Substrate	Brick
Dimensions	27'w x 45'h
Budget	\$60,000

Themes:

Catering to 1st to 3rd graders, mural will be the backdrop of a planned outdoor nature area. The artwork can evolve to reflect the growing maturity of the students. It should be energizing and empowering, with elements that represent the African diaspora and LatinX communities, as well as other cultures present in the school. The design should speak to all students, including those with special needs, making every child feel represented and valued in their place of learning.

*Artists proposing for both sites at this school may be considered.

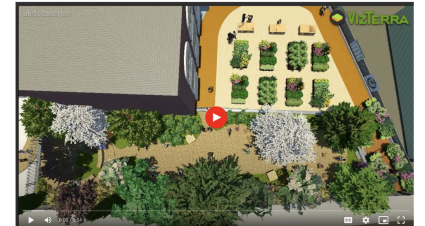

Outdoor Nature Area Plan

Call to Artists: A Canvas of Culture- BPS Murals | Project Sites
Raphael Hernandez K-8 Dual Language School | 61 School St., Roxbury, MA 02119

Interior/ Exterior	Exterior Right
Location	Front school entrance/ staff parking
Substrate	Brick
Dimensions	22.5'w x 22.5'h
Budget	\$30,000

Themes:

Culture and representation of the school's bilingual community is very important, embracing the school's core values "BRIA": Bilingualism, Respect, Inclusividad, Amor. Students are predominantly Latinx, Dominican & Puerto Rican. Artwork should be bright, colorful, and inviting while expressing joy, love, community, and celebration.

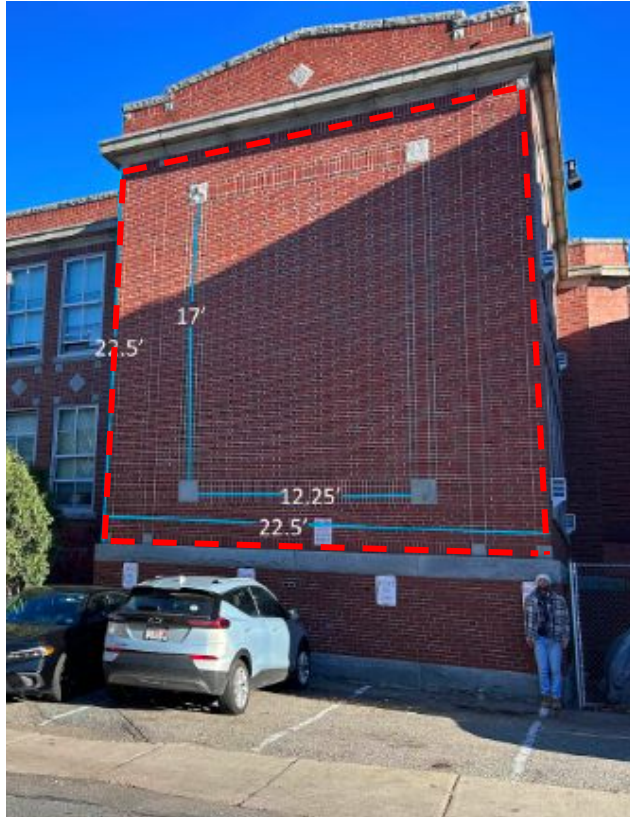

Call to Artists: A Canvas of Culture- BPS Murals | Project Sites
Hugh O'Donnell Elementary | 33 Trenton St., East Boston, MA 02128

Interior/ Exterior	Exterior
Location	School playground
Substrate	Concrete
Dimensions	127'w x 12'h (3 walls combined)
Budget	\$60,000

Themes:

Currently undergoing a playground renovation and seeking new artwork to replace existing murals. The artwork should embody themes of strength and resilience, drawing from the rich stories of the local Eagle Hill/ Latino community, primarily from South and Central America. It is essential for the artwork to be bilingual, reflecting the neighborhood's Spanish-speaking roots, and to incorporate elements of community engagement. The school's mascot is the Otter.



SCHEMATIC DESIGN:

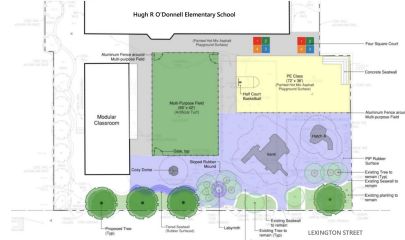

SEATWALLS / BLEACHERS

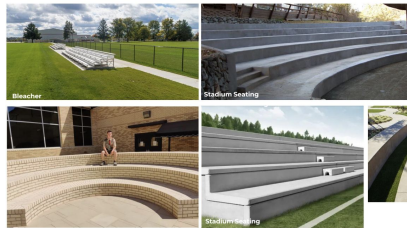

*Artists should consider wall prep at this site.

OPPORTUNITY 2

William E. Carter School

Mission:

Providing an accessible, developmentally appropriate educational environment.

Combine data driven instruction with individualized services and supports to maximize student access to learning.

Maintain a school wide instructional focus that increase each student's ability to communicate,

Help students realize their potential for independence and the highest possible quality of life.



Perkins&Will

Color Recognition

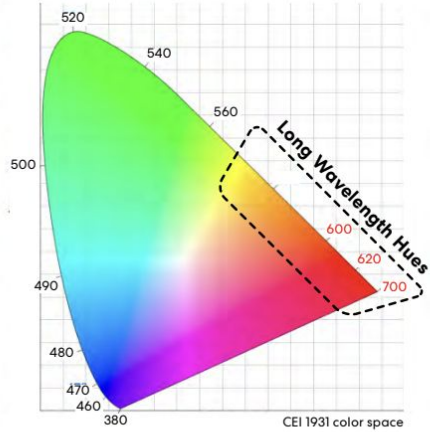

The Research

Research shows students who present cortical visual impairments (CVI) can more easily identify high wavelength hues.

Research- Informed Design (via Perkins & Will)

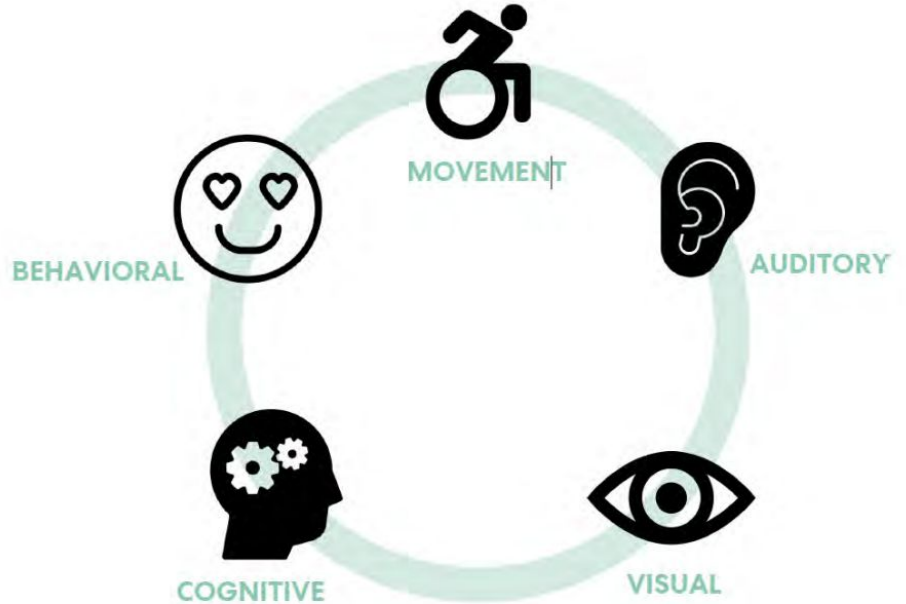

Call to Artists: A Canvas of Culture- BPS Murals | Project Sites
William E. Carter School | 396 Northampton St., (South End) Boston, MA 02118

Budget:
\$175,000

Themes:
A large-scale exterior facade at the north side of the building facing the MBTA platform, artists have the unique opportunity to tell the story of the Carter School, its mission, and values. The location of the school is also the site of Martin Luther King, Jr.'s former Boston address, adding historical significance to the connection of civil rights and the ADA movement.

- Additional Requirements:**
MBTA/Amtrak requirements for the artist/ artist team:
- Amtrak Training (online).
 - MBTA ROW Training (in-person).
 - Prepare a proposed work plan for review and approval by both the MBTA and Amtrak.

1. North Exterior Wall

Location:
North facing exterior wall

Size:
67'-0" x 50'-0" with potential to adjust size

Substrate:
Glazed Brick (gloss)

Audience:
-General Public

-MBTA platform

-Carter Students arriving by train

Perkins&Will



--- Scope Boundary

Budget:
\$40,000

Themes:
The Carter School serves students from ages 3-22. Artists creating artwork for this environment must carefully consider themes and functionalities that are age appropriate and resonate with the school's older, high school student population. The artwork should not only be visually appealing but also serve as a therapeutic and educational tool, enhancing sensory and learning experiences.

Additional Considerations:
A variety of 2D applications can be explored for this space. Please note: artwork that is wall-mounted must be "Class A fire-rated".

3. Interior Upper School Lounge

Location:
Level 2 Corridor wall opposite the upper school student lounge

Size:
63'-0" x 8'-0"
(Assumes 2' tile base for wall protection)

Substrate:
Drywall

Audience:
-Internal Carter Community and Guests



--- Scope Boundary

Perkins&Will

Budget:

\$40,000

Themes:

The Carter School's courtyard is a place for everyone. Artists are invited to create visually captivating artwork that supports the student population's sensory and learning experiences. Located outside the gym, the artwork should provide a stimulating and visually interesting environment. Colors should meet functional vision specifications.

Additional Considerations:

Artists proposing for the Level 2 Courtyard and Level 3 Garden Walls together will be considered.

2. Level 2 Courtyard Wall

Location:

Courtyard outside gymnasium and level 2 corridor

Size:

31'-9" X 17'-0"

Substrate:

Glazed Brick (gloss)

Audience:

-Internal Carter Community and Guests



Perkins&Will

--- Scope Boundary

Budget:

\$40,000

Themes:

For the walls in the school's garden area, the Carter School envisions a "sensory garden" and seeks artwork that enhances sensory experiences. Artists can incorporate visual, tactile, and/or auditory elements, exploring themes of nature and the growth cycle. Wall 4B will be integrated with a living plant wall, offering a unique canvas for artistic expression.

Additional Considerations:

Artists proposing for the Level 2 Courtyard and Level 3 Garden Walls together will be considered.

4. Level 3 Exterior Therapy Garden Walls

Location:

Level 3 Therapy Garden near exterior classroom and Pre-K classrooms

Size:

4A - 36'-0" x 7'-0"
4B - 36'-0" x 7'-0"
(two locations, one behind plant wall)

Substrate:

Glazed Brick (gloss)

Audience:

-Internal Carter Community and Guests

Perkins&Will



--- Scope Boundary

THANK YOU!

CITY of BOSTON

